

# REPLACEMENT PARTS SUITABLE FOR Thermal Dynamics®

## PCH/M-75, PCH/M-76

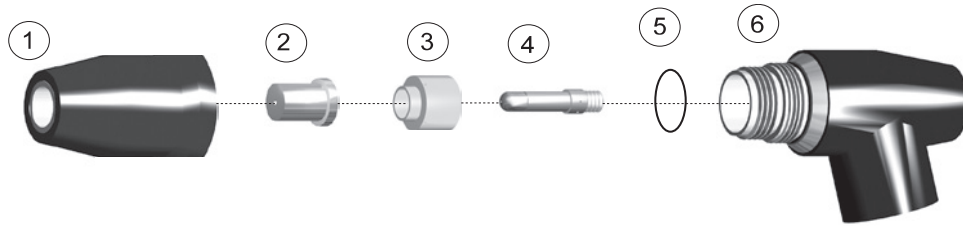

Item	Part No.	Ref. No.	Description	Std. Pkg.	Item	Part No.	Ref. No.	Description	Std. Pkg.
1.	T-1609	8-7500	Shield Cap	1	3.	T-1611	8-7501	Gas Distributor	5
	T-1706	8-7507	Crown Shield Cup	1		T-1709	8-7508	Gouging Gas Distributor	2
2.	T-1610	8-7504	Tip, 55 Amp	5	4.	T-1612	8-7502	Electrode	5
	T-2535	9-7726	Tip, 60 Amp	5	5.	T-1615	8-0532	O-Ring	1
	T-2534	9-7728	Tip, 80 Amp	5	6.	T-1613	8-7510	Torch Body 70°	1
	T-2126	8-7505	Tip, 70 Amp	5		T-2308	8-7512	Torch Body, Machine	1
	T-1707	8-7503	Drag Tip, 35 Amp	5	NS	T-2183	9-7501 OEM	Coil Spring	1
	T-1708	8-7506	Gouging Tip	5					

## ACCESSORIES

### Hand Torch

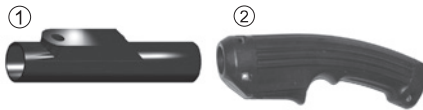

### Machine Torch

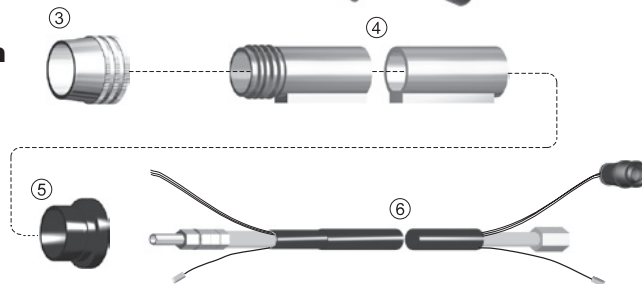

Item	Part No.	Ref. No.	Description	Std. Pkg.	Item	Part No.	Ref. No.	Description	Std. Pkg.
1.	T-0155	8-1322	Retaining Sheath	1	NS	T-1713	4-7502	Machine Leads, NonShielded, 25'	1
2.	T-1040	9-5636-1	Handle with Switch	1	NS	T-1714	4-7503	Machine Leads, NonShielded, 50'	1
3.	T-0157	8-4018	Nut	1	NS	T-2896	2-0001	100XL Torch 70° with 25' Leads	1
4.	T-0159	8-5005	Mounting Tube	1	NS	T-2897	2-0002	100XL Torch 70° with 50' Leads	1
5.	T-0161	8-4204	Bushing	1	NS	T-2890	2-7501	75 Torch, 70° with 25' Leads	1
6.	T-1711	4-7500	Hand Leads, NonShielded, 25'	1	NS	T-2891	2-7502	75 Torch, 70° with 50' Leads	1
	T-1712	4-7501	Hand Leads, NonShielded, 50'	1	NS	T-2919	4-7611	25' Leads	1
	T-0759	4-0010	Hand Leads, 100XL, NonShielded, 25'	1	NS	T-2920	4-7612	50' Leads	1

VERIFY POWER SUPPLY WHEN ORDERING LEADS

Last update of this page: 18/11/2016. See Revision history for details.

**THERMACUT®**  
THE CUTTING COMPANY

WWW.THERMACUT.CZ  
TEL.: +420 556 423 418  
SALES@THERMACUT.CZ

WWW.THERMACUT.DE  
TEL.: +49 (0) 27 39 40 33 0  
INFO@THERMACUT.DE

WWW.THERMACUT.COM  
TEL.: 1-603-542-6715  
CUSTOMERSERVICE@THERMACUT.COM

THERMACUT®, FHT-EX® AND EX-TRAFIRE® ARE REGISTERED TRADEMARKS OF THERMACUT S. R. O. AND MAY BE REGISTERED IN CZECH REPUBLIC AND/OR OTHER COUNTRIES. ALL OTHER TRADEMARKS ARE PROPERTIES OF THEIR RESPECTIVE OWNERS. THERMACUT IS NO WAY AFFILIATED WITH Thermal Dynamics®. MOST THERMACUT PARTS ARE MADE FOR OR BY AN IBG COMPANY. PARTS INDICATED WITH A OEM ARE ORIGINAL PARTS MANUFACTURED BY THE ABOVE NAMED MANUFACTURER AND ARE BEING RESOLD BY THERMACUT. THERMACUT RESERVES THE RIGHT TO SUBSTITUTE OEM PARTS IN PLACE OF THERMACUT PARTS. VALID FROM NOVEMBER 2016 • PREVIOUS VERSION IS NO LONGER VALID. • © COPYRIGHT 2016 BY THERMACUT® CZECH REPUBLIC. ALL RIGHTS RESERVED.