

# REPLACEMENT PARTS SUITABLE FOR Thermal Dynamics®

## PCH/M-53 TORCH

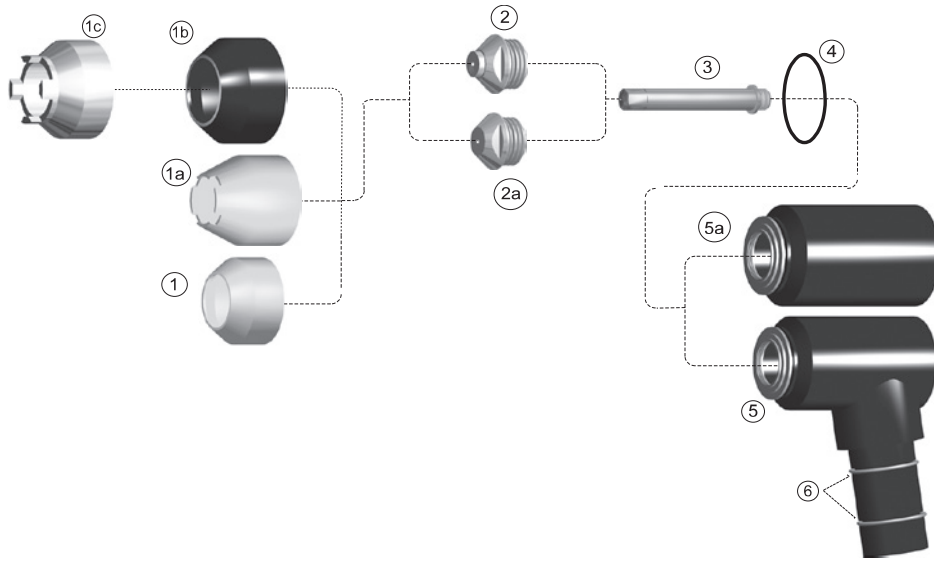

Item	Part No.	Ref. No.	Description	Std. Pkg	Item	Part No.	Ref. No.	Description	Std. Pkg.
1.	T-0166	9-5617	Shield Cup	10	4.	T-0151	8-5525	O-Ring	10
1a.	T-0168	9-5694	Crown Shield Cup	10	5.	T-1335	9-6170	Hand Torch with Handle	1
	T-0169	9-5694-1	Crown Shield Cup, SR	1	5a.	T-1336	9-6180	Machine Torch	1
1b.	T-0186	9-5781	Shield Cup, Long, SR	1	NS	T-0185	8-5130	Heat Shield	1
1c.	T-0188	9-5780	Shield Cup, Metal	1	NS	T-0189	8-4007	Tip Wrench	1
2.	T-1312	9-5897	Tip, Cutting	10	NS	T-0190	9-5620	Electrode Wrench	10
2a.	T-1313	8-5129	Tip, Gouging	5	NS	T-0163	8-4025	Lubricant	1
3.	T-0176	9-5619	Electrode, Air	10					

## ACCESSORIES

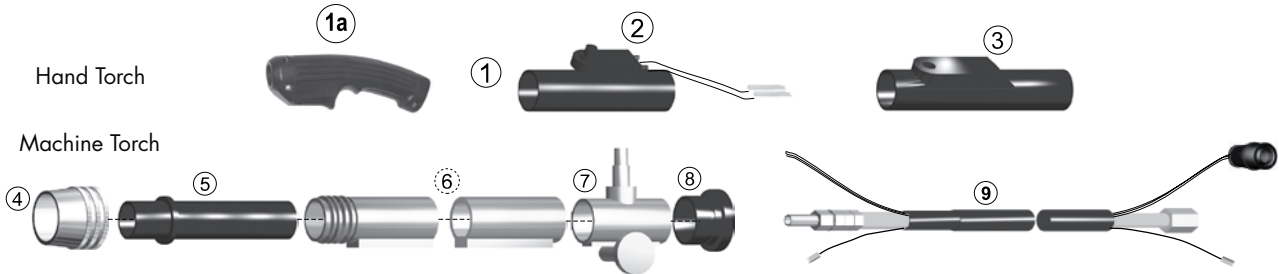

Item	Part No.	Ref. No.	Description	Std. Pkg	Item	Part No.	Ref. No.	Description	Std. Pkg.
1.	T-0180	9-5644	Handle	1	7.	T-0160	7-2827 OEM	Pinion Assembly	1
1a.	T-1040	9-5636-1	Handle with Switch	1	8.	T-0161	8-4204	Bushing	1
2.	T-0181	9-5522	Switch	1	9.	T-1674	4-6048	Hand Leads, 25'	1
3.	T-0182	8-4216	Retaining Sheath	1		T-1675	4-6050	Hand Leads, 50'	1
4.	T-0157	8-4018	Nut	1		T-1676	4-6049	Machine Leads, 25'	1
5.	T-0183	9-1901	Adapter	1		T-1677	4-6051	Machine Leads, 50'	1
6.	T-0159	8-5005	Mounting Tube	1					

Last update of this page: 18/05/2017. See Revision history for details.

**THERMACUT®**  
THE CUTTING COMPANY

WWW.THERMACUT.CZ  
TEL.: +420 556 423 418  
SALES@THERMACUT.CZ

WWW.THERMACUT.DE  
TEL.: +49 (0) 27 39 40 33 0  
INFO@THERMACUT.DE

WWW.THERMACUT.COM  
TEL.: 1-603-542-6715  
CUSTOMERSERVICE@THERMACUT.COM

THERMACUT®, FHT-EX® AND EX-TRAFIRE® ARE REGISTERED TRADEMARKS OF THERMACUT, K. S. AND MAY BE REGISTERED IN CZECH REPUBLIC AND/OR OTHER COUNTRIES. ALL OTHER TRADEMARKS ARE PROPERTIES OF THEIR RESPECTIVE OWNERS. THERMACUT IS NO WAY AFFILIATED WITH Thermal Dynamics®. MOST THERMACUT PARTS ARE MADE FOR OR BY AN IBC COMPANY. PARTS INDICATED WITH A OEM ARE ORIGINAL PARTS MANUFACTURED BY THE ABOVE NAMED MANUFACTURER AND ARE BEING RESOLD BY THERMACUT. THERMACUT RESERVES THE RIGHT TO SUBSTITUTE OEM PARTS IN PLACE OF THERMACUT PARTS. VALID FROM MAY 2017 • PREVIOUS VERSION IS NO LONGER VALID. © COPYRIGHT 2017 BY THERMACUT® CZECH REPUBLIC. ALL RIGHTS RESERVED.